

# NSP | AIRWING

Thank you for your trust in NSP products. The bag you are about to open contains the items 1-5 of the below overview:



- 1 An NSP AirWing in the size of your choice
  - 2 A pump nozzle adapter, suitable for every pump with a Hulkey Roberts Nozzle\*
  - 3 2 Pieces of TPU repair batch for the bladder of the NSP AirWing
  - 4 Leash
  - 5 AirWing Bag
- 
- 6 Wingtip
  - 7 Leading edge
  - 8 Strut

*\* We recommend to purchase the NSP designed low pressure pump*

## INFLATING YOUR NSP AIRWING

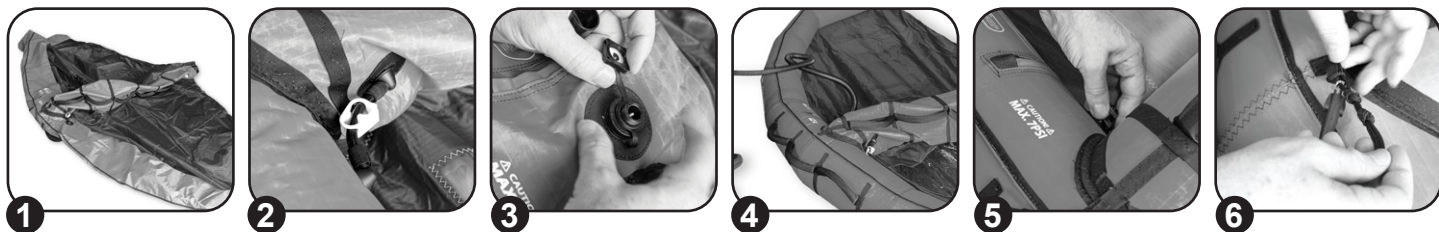

- 1 Lay your wing flat on a non-abrasive surface with the strut (and valve) facing up
- 2 Make sure the hose clamp connecting the strut and leading edge is opened
- 3 Open the Boston high-volume valve, and secure the bottom ring by turning it clockwise
- 4 Use the pump nozzle adapter if necessary, and pump up the strut and leading edge to 7psi\*
- 5 Remove the pump, tighten the cap. Next, close hose clamp connecting strut and leading edge
- 6 Secure your leash to the Airwing and yourself before entering the water

*\* NOTE: the inflated pressure is only shown at the end of every stroke on the pump gauge. It's not shown permanently.*

## DEFLATING YOUR NSP AIRWING

- 1 Make sure your NSP Airwing is on a surface free of sharp items
- 2 Open the hose clamp connecting leading edge and strut
- 3 Unscrew the valve while turning the bottom ring counterclockwise to release all air
- 4 Starting at the wingtips, roll them towards the strut while deflating the leading edge
- 5 With the leading edge deflated, begin at the strut tip to roll up the strut and deflate it too
- 6 Put the rolled-up NSP Airwing in the supplied bag for easy and proper storage